BOSTON 2026



WORLD EXPO

The Twelfth International Philatelic Exhibition in the United States

May 23-30, 2026

Boston Convention and
Exhibition Center

Boston 2026 World Stamp Show, Inc.

Who Puts Together This Event?

- Boston 2026 World Stamp Show, Inc. - Organizing Committee, in partnership with:
 - American Philatelic Society
 - United States Postal Service
 - Smithsonian National Postal Museum
 - Spellman Museum of Stamps and Postal History
- Countless Philatelic Organizations, Supporters and Volunteers

“A Collector-Supported Exhibition”

Boston 2026 Organization



Nancy Clark

President Emerita

Corporate Officers:

8 members

Organizing Committee:

26 members

Core Committee:

3 members

Advisors:

7 members

Boston Convention and Exhibition Center

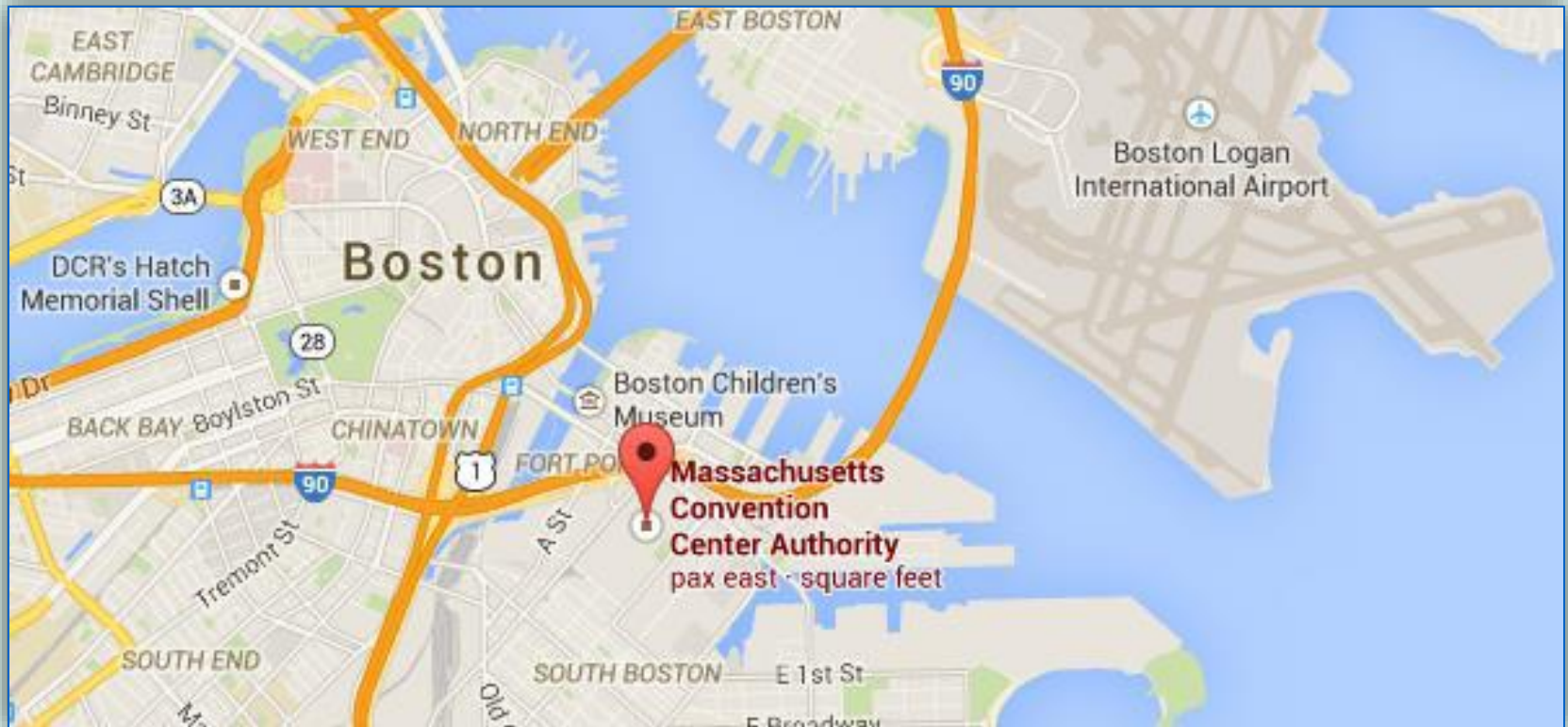

Less than 2 miles from Logan Airport (public transportation is available).
0.6 miles from South Station train terminal.

Boston Convention and Exhibition Center



Boston Convention and Exhibition Center

- 352,000 sf of contiguous exhibit space (Halls A & B)
- Minimal pillar obstruction
- 19,000 sf of registration area
- State of the art technology and climate control (free WiFi)
- 42 meeting rooms of various sizes
- 20,000 sf column-free ballroom with capacity for 1,500 diners
- Food court
- 62 covered loading bays
- Ample onsite parking (~2,000 spaces)
- Easy to reach by public transportation or driving

Boston Convention and Exhibition Center

Lower Level (Show Floor)

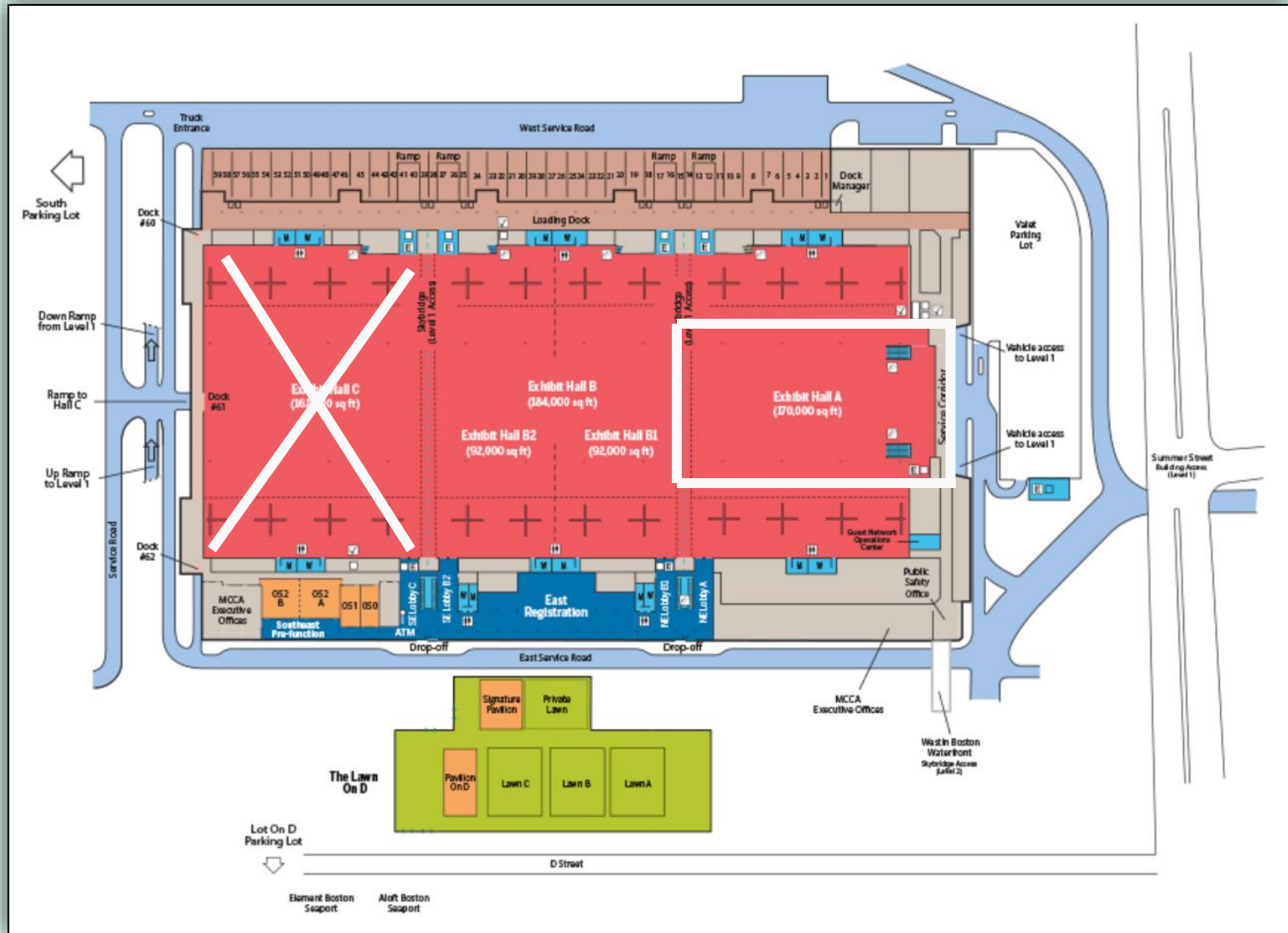

Boston Convention and Exhibition Center



Boston Convention and Exhibition Center Upper Level (Meeting Rooms and Lobby)

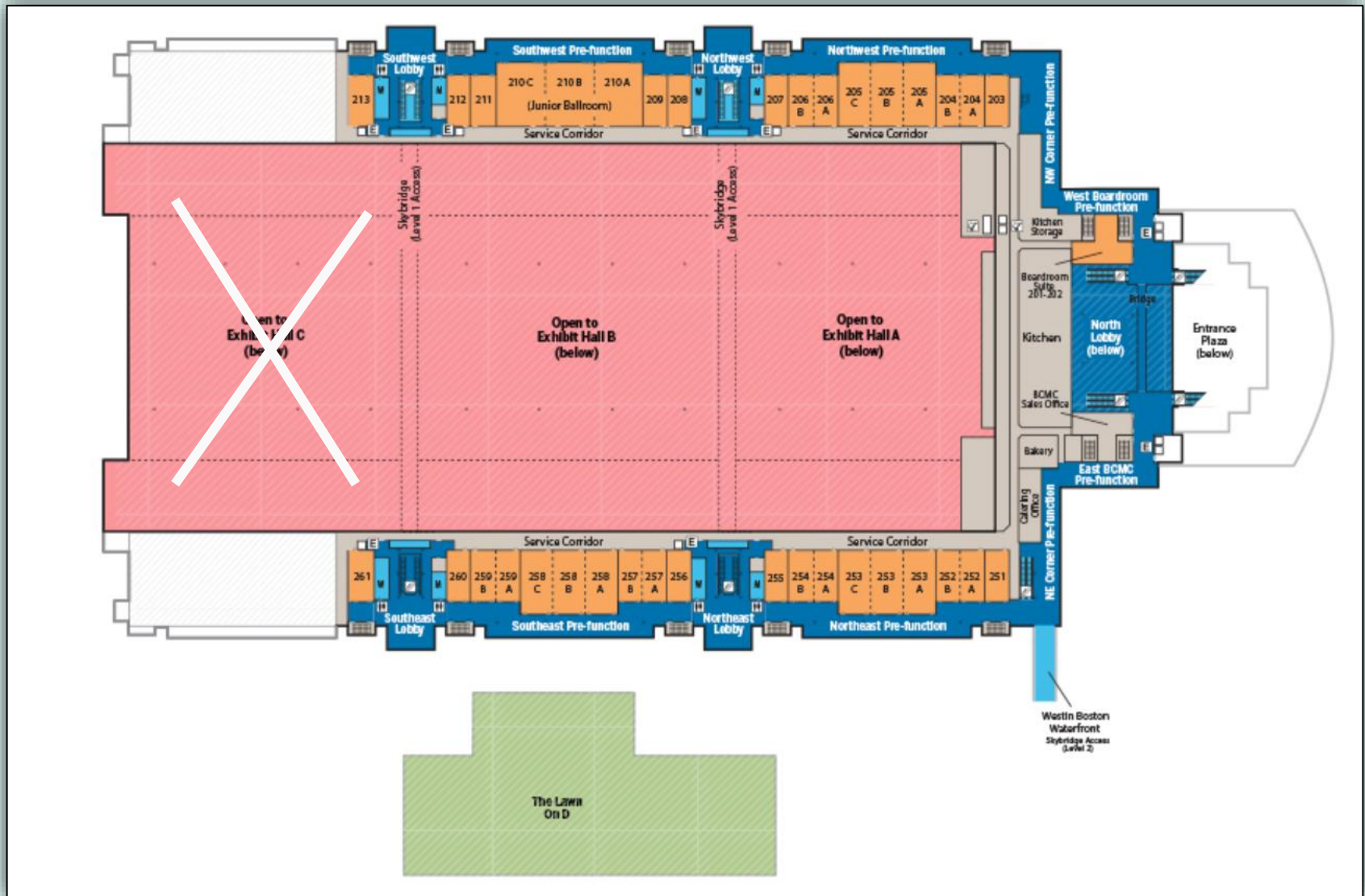

Two Show Hotels Directly Connected to the Convention Center

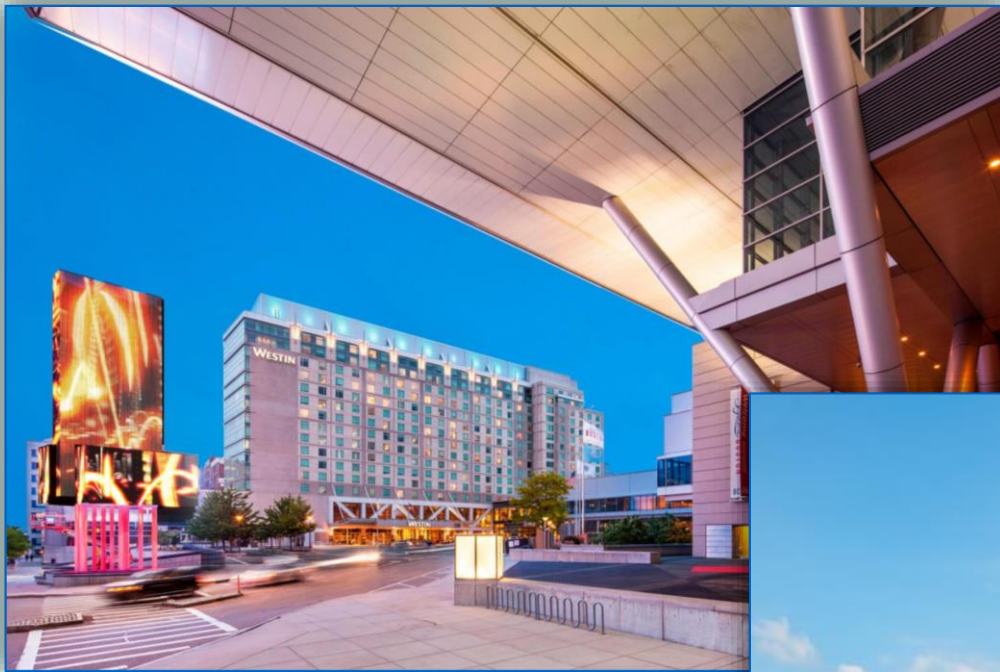

Westin Boston Seaport District
Show Headquarters
Contracted in 2015



Omni Boston Hotel at the Seaport
Opened September 2021
Contracted in 2021

Some of the Other Nearby Show Hotels

Aloft Boston Seaport District - Across the street from BCEC

Element Boston Seaport District - Across the street from BCEC

Hampton Inn Boston Seaport - Three blocks from BCEC

Homewood Suites Boston Seaport - Three blocks from BCEC

Hyatt Place Boston Seaport District - Four blocks from BCEC

Yotel Boston - Four blocks from BCEC

Several More Economy Hotels to be Contracted

Decorator: Heritage

Booking Manager: OnPeak

Dealer Options

- Booth Sharing (two max)
- Half Show Option (pipe & drape)
- Booth and Hotel Packages

Museum Participation



Smithsonian
National Postal Museum

SPELLMAN

MUSEUM OF STAMPS
AND POSTAL HISTORY

Massachusetts
Historical Society
Founded 1791

Main Society Sponsors to Date

\$100,000



\$50,000



\$25,000



United States Stamp Society

Main Society Sponsors (continued)

\$12,500



\$10,000

Northeastern Federation of Stamp Clubs
Supporting New England Philately



Robert A. Siegel
AUCTION GALLERIES, INC.

\$5,000



Booths

Booth sizes, configurations, prices and locations are listed on the website: www.Boston2026.org

Booth selection just started

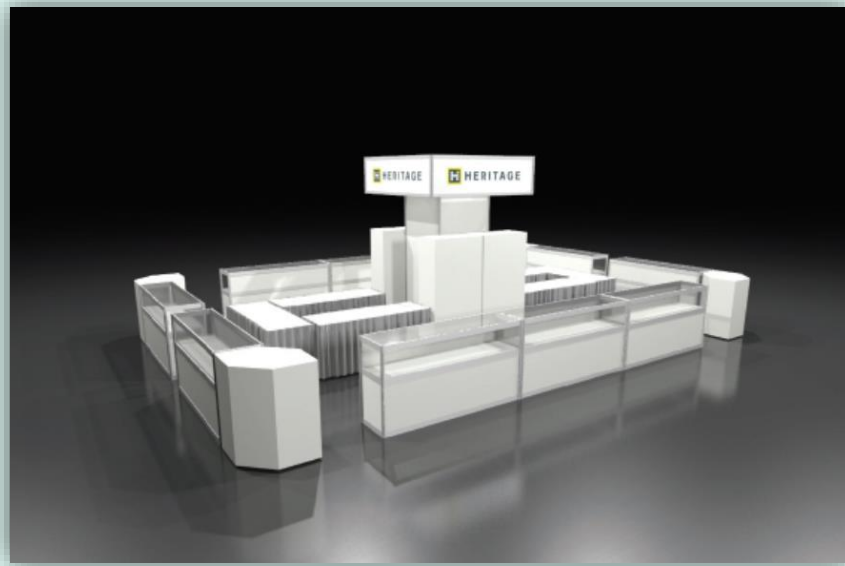

30 x 20 Super Booth

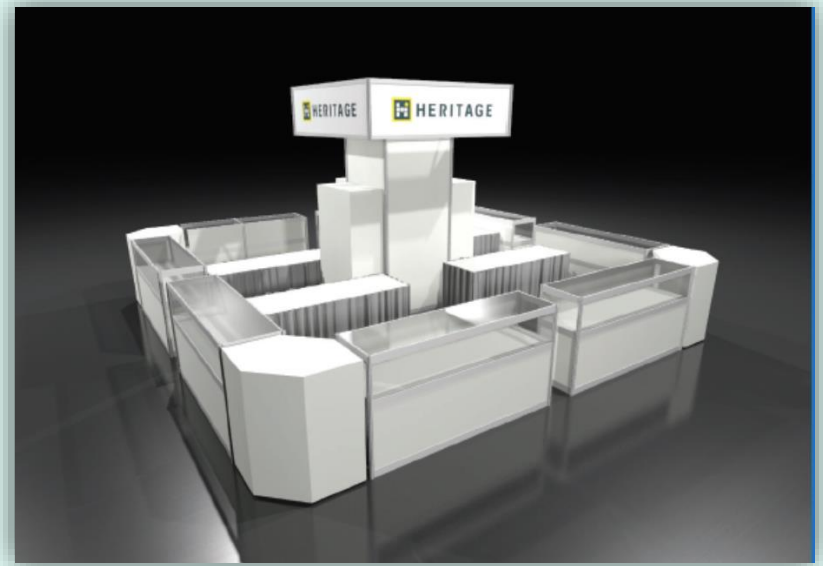

20 x 20 Super Booth

Frames



One Lock at
the Bottom

Frames

- Estimated Frames Needed:
4,000
- Approximate Refurbishing Cost:
\$100/frame
- Available Frames in the US:
7,000 to 8,000
- Transportation and Storage Cost:
Variable

The Exhibition



Types of Exhibits

- Competitive exhibits (four pavilions)
- Invited exhibits
- Court of Honor (world rarities)
- Museum exhibits (philatelic and historical)
- Other attractions for the general public

Competitive Exhibits

- FIP categories
- First Day Covers (FIP experimental class)
- APS annual Champion of Champions
- Polar Salon
- Cinderella exhibits
- Ephemera exhibits
- Paper Money exhibits ??

Other Events during Boston 2026

- United States Semiquincentennial Celebration in Boston
- Signing of the Roll of Distinguished Philatelists Ceremony
- American Philatelic Society annual Champion of Champions competition
- Inter American Federation of Philately (FIAF) Annual Assembly
- World Cinderella Philately Congress (signing of the Roll of NCP)
- Polar Salon
- UPU Philatelic Marketing Conference
- FIP Centennial Congress ???
- National Postal Forum ???

Non-Philatelic Attractions at Boston 2026

- Museum exhibits
- Lego display
- Printing display
- Historical Artifacts
- Revolutionary War reenactments
- Book presentations and signing

Volunteers

We will need over
500 volunteers!

Boston 2026 World Expo: Summary

- FREE admission
- 4,000 exhibit frames
- US Postal Service
- American Philatelic Society
- Several Museums
- Daily First Day Ceremonies (US and Foreign)
- 150 Dealers and Auction Houses
- 135 Societies and Organizations
- 50 Postal Administrations
- 200+ meetings, seminars and events
- On Site Auctions
- StampCon ???

Fundraising Goals

- Estimated Need: ~ \$1,000,000
- Donations and Pledges: ~ \$650,000

So far, we have more than 100 individual donors and over two dozen organizations

Donors of at least \$1,000 will have unlimited access to the **Minuteman Club**

Thanks for your attention

